



2020 Census Local Update of Census Addresses Operation (LUCA)

Agenda

- The Current Surveys and Decennial Census
- 2020 Census Design
- Address List Maintenance 2010 - 2020
- LUCA
 - Background
 - Confidentiality and Security
 - What's New for LUCA
 - Who Can Participate
- Preparation for LUCA Participation
 - Early Tools
 - Participation Methods
 - Product Formats (Address List & Maps)
 - Next Steps
 - Schedule

New York Regional Office

- Massachusetts as well as the rest of New England, New York, New Jersey and Puerto Rico comprise the New York Regional Office territory.
- We are in your neighborhood every day collecting data about the economy, the people, housing and other aspects of community life used by government, planners, entrepreneurs, students and everyone who is curious about the nation!
- The New York Regional Office employs approximately 120 permanent, part-time employees in Massachusetts who call or visit households and businesses to obtain survey data for numerous surveys we conduct for the Census Bureau and other federal agencies.

Current Surveys

American Community Survey (ACS)

- Annual Social, Economic and Housing data
- Both Housing Units and Group Quarters

Other Surveys and Censuses

- Current Population Survey (CPS)
- National Crime and Victimization Survey (NCVS)
- Health Interview Survey (HIS)
- Consumer Expenditure Survey (CE)
- Population Estimates
- Economic Census
- Census of Governments
- Demographic Area Address Listing (DAAL)

Periodic Surveys

- American Housing Survey (May-August 2017)

The Decennial Census

The purpose is to **conduct** a census of population and housing and **disseminate** results to the President, the States and the American People

- Uses of Census data:
 - **Apportion** representation among states as mandated by Article 1, Section 2 of the US Constitution
 - **Draw** congressional and state legislative districts, school districts and voting precincts
 - **Enforce** voting rights and civil rights legislation
 - **Distribute** federal dollars to states
 - **Inform** planning decisions of federal, tribal, state and local government
 - **Inform** organizational decisions (e.g., where to locate, size of market, etc.) of businesses and non-profits

2020 Census Design

The 2020 Census: A New Design for the 21st Century

Motivate People to Respond

Conduct a nation-wide communications and partnership campaign

- Maximize outreach using traditional and new media
- Target ads to specific audiences
- Work with trusted sources to inspire participation.



Establish Where to Count

Identify all addresses where people could live

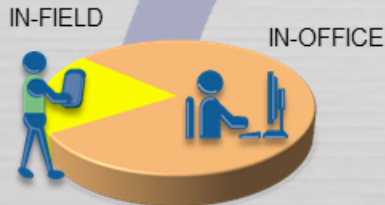

- Conduct a 100% review and update of the nation's address list
- Minimize field work with in-office updating
- Use multiple data sources to identify areas with address changes
- Get local government input

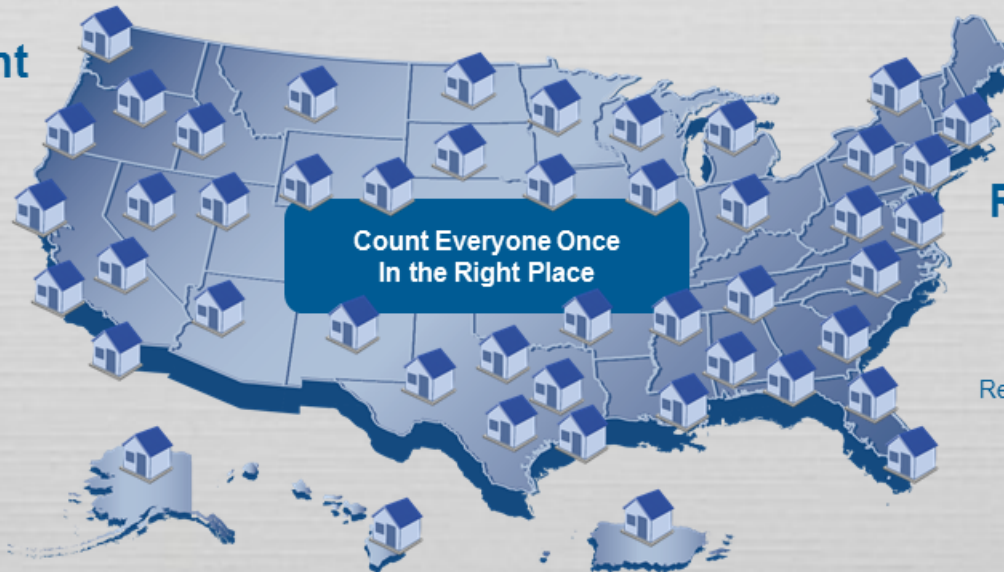

**Count Everyone Once
In the Right Place**

TELEPHONE
AND PAPER SELF-
RESPONSE

NONRESPONSE
FOLLOWUP

INTERNET SELF-RESPONSE

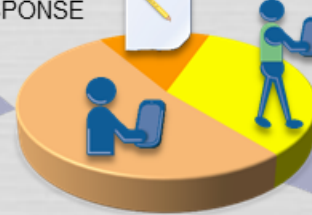

Count the Population

Collect data from all households, including group and unique living arrangements

- Make it easy for people to respond anytime, anywhere
- Encourage people to use the new online response option
- Use the most cost-effective strategy to contact and count nonrespondents
- Knock on doors only when necessary
- Streamline in-field census-taking

Release Census Results

Process and Provide Census Data

- Deliver apportionment counts to the President by December 31, 2020
- Release counts for redistricting by April 1, 2021
- Make it easier for the public to get data



Address List Maintenance 2010 - 2020

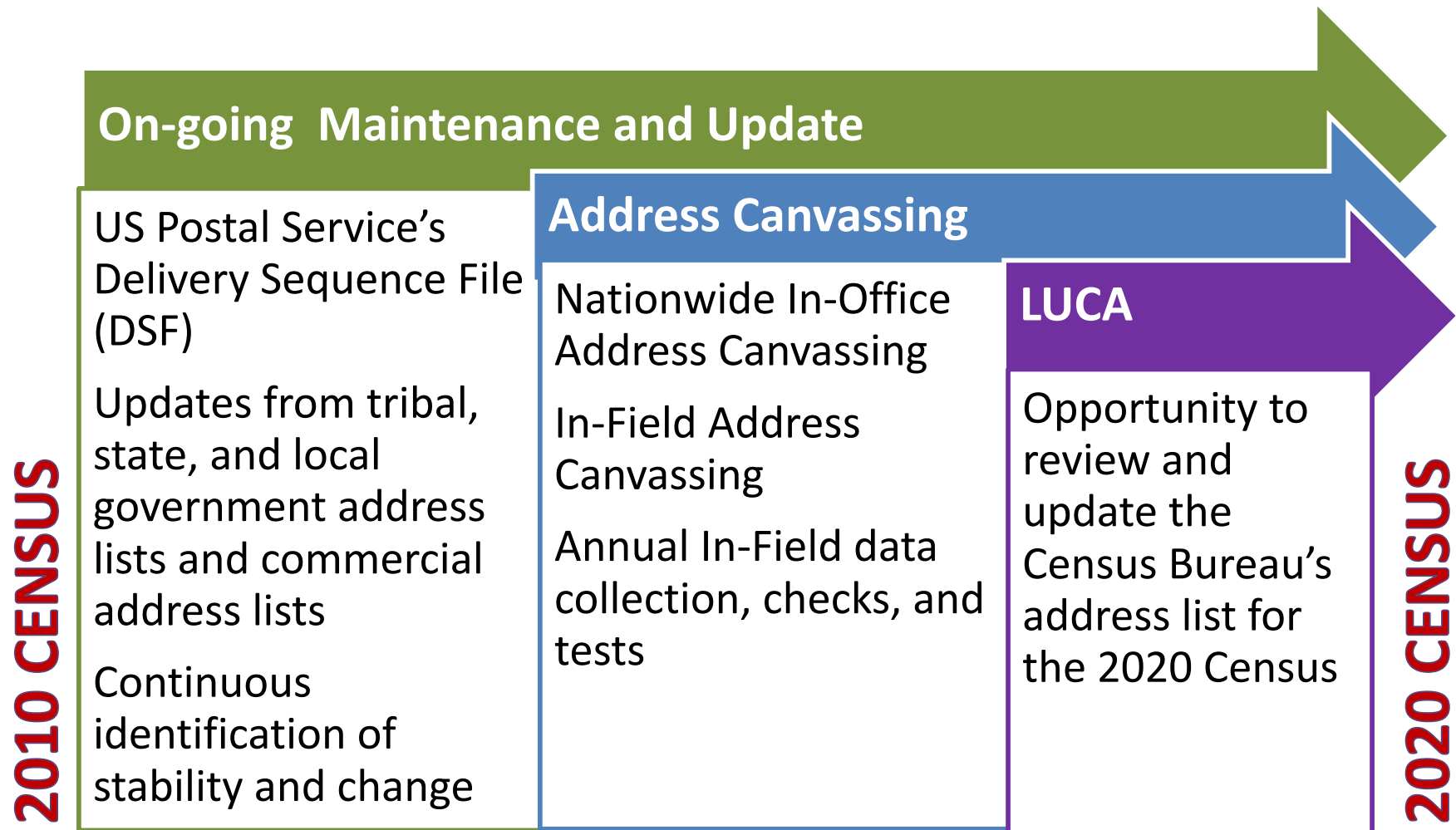

Geographic Support System (GSS) Program

- Integrated program of improved address coverage, continual spatial and feature updates, and enhanced quality assessment and measurement
- Supports and maintains the geographic and cartographic infrastructure necessary for the Census Bureau's data collection, processing, tabulation, and dissemination programs for the United States and Puerto Rico
- Provides for continual updates throughout the decade to support current surveys and the 2020 Census

LUCA Background

- Authorized by the Census Address List Improvement Act of 1994 (Public Law 103-430)
- Implemented in the support of the 2000 Census and refined to support the 2010 Census
- Provides a voluntary opportunity for designated representatives of tribal, state and local governments to review and comment on the addresses used to conduct the decennial census

Confidentiality and Security

Information provided to/from LUCA is covered under Title 13 of the United States Code which:

- Requires the Census Bureau to ensure confidential treatment of census-related information, including individual addresses and map structure points
- Requires all liaisons, reviewers, and anyone with access to Title 13 materials abide by Confidentiality and Security Guidelines
- Requires the Census Bureau maintain the confidentiality of all information it collects

What's New for 2020 LUCA

- **Offers** streamlined participation – Full Address List Review
- **Provides** the digital address list in convenient standard software formats
- **Includes** ungeocoded address records for state and county participants
- **Requires** residential multi-unit structure identifiers (e.g., Apt 1, Unit A2, #3001, etc.)
- **Includes** residential structure coordinates, if available
- **Allows** participants to submit residential structure coordinates, if available
- **Allows** participants to submit non-city style addresses with corresponding map spot

Who can participate in LUCA

- Federally recognized tribes with a reservation and/or off-reservation trust land
- States
- Counties
- Incorporated places
 - Cities, towns, boroughs, or villages
- Townships (Minor Civil Divisions)

Preparation - Early Tools

2020 LUCA Address Block Count List

- Provides access to an address count list which includes the count of residential addresses and group quarters by block

	A	B	C	D	E	F	G
1	State	County	Tract	BLOCK	BLOCK_GEOID	Total Residential	Total Group Quarters
2	21	051	9501.00	1000	210519501001000	0	0
3	21	051	9501.00	1001	210519501001001	1	0
4	21	051	9501.00	1002	210519501001002	0	0
5	21	051	9501.00	1003	210519501001003	7	0
6	21	051	9501.00	1004	210519501001004	0	0
7	21	051	9501.00	1005	210519501001005	0	0
8	21	051	9501.00	1006	210519501001006	0	0
9	21	051	9501.00	1007	210519501001007	0	0
10	21	051	9501.00	1008	210519501001008	2	0
11	21	051	9501.00	1009	210519501001009	28	0
12	21	051	9501.00	1010	210519501001010	0	0
13	21	051	9501.00	1011	210519501001011	37	0

Preparation - Early Tools

Census Geocoder

- Takes individual addresses or file of addresses and obtains coordinates and census geography
- Geocoder updates include:
 - Increasing the maximum number of records for batch processing from 1,000 to 10,000
 - Providing larger governments another means to submit addresses to be geocoded

Preparation - Participation Methods



Geographic Update Partnership Software (GUPS)



Paper Format - Address List and Maps



Digital Format - Address List and Maps

GUPS – Participation Method

- Customized Geographic Information System (GIS) software for participation in 2020 LUCA
- Pre-packaged to include all components
- Designed for participants with no GIS experience
- Allows for simple to complicated reviews and edits
- Programmed with a review tool to validate LUCA edits
- No internet connection required

Geographic Update Partnership Software (GUPS)

QGIS 2.8.3 - Wien - PL2430900 - GUPS *** Disclosure Prohibited by Title 13 U.S.C. ***

Project Edit View Layer Settings Vector Raster Processing Help GUPS

The screenshot displays the QGIS interface with a map of Frostburg city. The map shows District 11, West Frostburg; District 26, Frostburg; and District 12, East Frostburg. The city of Frostburg and Frostburg State University are also labeled. Two address count lists are visible:

Census Address List

	MAFID	Action	ST	COU	Tract	Block	GEOID	GQ	House #	Street Name	Apt/U
2504	000000001		24	001	0018.00	1055	240010018001055			Gold Fish HWY	
2505	000000002		24	001	0018.00	1055	240010018001055			Nemo HWY	
2506	000000003		24	001	0018.00	1055	240010018001055			HotdogBEER LANE	
2507	000000004		24	001	0018.00	1055	240010018001055			Gold Fish LANE	

Address Count List

	STATE	COUNTY	TRACT	BLOCK	GEOID
17	24	001	0016.00	1012	2400100160010
25	24	001	0016.00	1014	2400100160010
53	24	001	0016.00	1019	2400100160010
47	24	001	0016.00	1020	2400100160010
40	24	001	0016.00	1049	2400100160010
50	24	001	0016.00	1050	2400100160010
273	24	001	0016.00	1051	2400100160010
10	24	001	0016.00	1052	2400100160010
212	24	001	0016.00	1053	2400100160010
151	24	001	0016.00	1054	2400100160010
176	24	001	0016.00	1055	2400100160010
76	24	001	0016.00	1057	2400100160010
202	24	001	0016.00	1058	2400100160010
171	24	001	0016.00	1059	2400100160010
51	24	001	0016.00	1060	2400100160010
56	24	001	0016.00	1061	2400100160010
268	24	001	0016.00	1064	2400100160010
93	24	001	0016.00	1067	2400100160010
250	24	001	0016.00	1069	2400100160010
108	24	001	0016.00	1070	2400100160010
179	24	001	0016.00	1071	2400100160010
31	24	001	0016.00	1072	2400100160010
218	24	001	0016.00	1073	2400100160010
72	24	001	0016.00	1075	2400100160010

Coordinate: -78.8892,39.6369 Scale: 1:33,456

Geographic Update Partnership Software (GUPS)

* Indicates required field

Non-Title 13 Example

This is a Group Quarters Address

STCOU : 24027

Tract : * 6069.07

Block : * 3000

House Number : * 101

Street Name : * ? Any Street Ave

Apartment/Unit # : ?

Zip Code : 20014

Address Use: M - Mailing

Longitude : -76.8427486128 Latitude : 39.1155212927

Add Map Spot Clear Map Spot OK Copy Cancel

Preparation – Address List Formats

- Paper
 - Available to governments with 6,000 or fewer addresses
 - Legal size (8.5” x 14”) – 6 addresses per page
 - Two sorts:
 - Street Name/House Number
 - Census Tract number/Block number/Street Name/House Number
 - Separate ‘Add Page’
- Digital
 - Available to all governments
 - Excel (.xlsx) or Comma Delimited Text (.csv) format
 - No separate ‘Add Page’

Paper - Address List

Form D-2007
(XX-XX-XXXX)
OMB Control No. 0607-0994

ADDRESS LIST 2020 LOCAL UPDATE OF CENSUS ADDRESSES OPERATION (LUCA)

U.S. DEPARTMENT OF COMMERCE
ECONOMICS AND STATISTICS ADMINISTRATION
U.S. CENSUS BUREAU

Sort: Street Name/House Number
Entity: Winter County CO88009

Page: 5 of 20
Date: 01/04/2018

DISCLOSURE PROHIBITED BY TITLE 13, U.S.C.

1 Line Number	2 MAFID	3 Action Code	4 Census Geographic Location of Address			5 GQ Flag	6 City Style Mail Delivery Address or E-911 Address or Physical Location Description and Road Name				7 Noncity-Style Mail Delivery Address (RR Number, HCR Number, PO Box Number)	8 Map Spot Number	9 City-Style Address Flag	10 Map Spot ID Coordinates	
			(4a) State County Code	(4b) Census Tract	(4c) Census Block		(6a) Complete Address Number	(6b) Complete Street Name	(6c) Group Quarters Name	(6d) Facility Name or Physical Location Description				(6e) Apt/ Unit Number	(6f) City- Style ZIP Code
25	999999993		88009	0045.00	1055		4007	AMPHORA ST			99997		3	Y	40.361373 -73.543799
26	999999994		88009	0045.00	1055		4009	AMPHORA ST			99997		4	Y	40.361377 -73.543799
27	999999995		88009	0045.00	1058		5001	AMPHORA ST			99997		1	Y	40.361381 -73.543799
28	999999996		88009	0045.00	1058		5003	AMPHORA ST			99997		2	Y	40.3613785 -73.543799
29	999999997		88009	0045.00	1065		402	W CAMERON AVE			99997		11	Y	40.3613791 -73.543799
30	999999999		88009	0045.00	1065		404	W CAMERON AVE			99997		12	Y	40.3613796 -73.543799

Action Codes

C – Correction to this address D – Delete this address J – Address is not in this Jurisdiction N – Address is Nonresidential

FICTITIOUS INFORMATION –FOR EXAMPLE ONLY

NO TITLE 13 DATA DISPLAYED

DISCLOSURE PROHIBITED BY TITLE 13, U.S.C.



U.S. Department of Commerce
Economics and Statistics Administration
U.S. CENSUS BUREAU
census.gov



Paper – Address List Add Page

Form D-2008
(XX-XX-XXXX)
OMB Control No. 0607-0994

U.S. DEPARTMENT OF COMMERCE
ECONOMICS AND STATISTICS ADMINISTRATION
U.S. CENSUS BUREAU

PAGE _____ OF _____ PAGES

ADDRESS LIST ADD PAGE 2020 LOCAL UPDATE OF CENSUS ADDRESSES OPERATION (LUCA)

Name of Preparer: _____
(Print Name)

Date Completed: _____
(MM/DD/YYYY)

Add Page For: _____
(Entity Name)

Entity ID Code: _____
(Copy from Address List Page)

1 Line #	2 Census Geographic Location of Address				3 Enter "Y" if this is a Group Quarters	4a Complete Address Number	4 Residential Address			5 Unique Map Spot Number	6 Address Use, if known M=Mailing L=Location B=Both
	(2a) State Code Number	(2b) County Code Number	(2c) Census Tract Number	(2d) Census Block Number			(4b) Complete Street Name	(4c) Group Quarters Name	(4d) Facility Name		

Example

DISCLOSURE PROHIBITED BY TITLE 13, U.S.C.



U.S. Department of Commerce
Economics and Statistics Administration
U.S. CENSUS BUREAU
census.gov



Address List Structure

LUCA 2010 – 26 Fields

Entity ID
Line #
MAFID
Action
State
County
Tract
Block
GQ Flag
House Number
Street Name Prefix Qualifier
Street Name Prefix Direction
Street Name Prefix Type
Street Name
Street Name Suffix Type
Street Name Suffix Direction
Street Name Suffix Qualifier
Location Description or GQ Name
Apartment/Unit Number
ZIP Code
Non-city style Mailing Address
Non-city style ZIP Code
Structure Point
Latitude
Longitude
City-Style Flag



LUCA 2020 – 24 Fields

Line #
MAFID
Action
Entity ID
State
County
Tract
Block
GEO ID
GQ Flag
House Number
Street Name
Apartment/Unit #
ZIP Code
GQ Name
Facility Name
Location Description
Non-city style Mailing Address
Non-city style ZIP Code
Mapspot ID
Address Use
Latitude
Longitude
City-Style Flag

Preparation – Map Formats

- Paper
 - Available to all governments
 - Two types of paper map materials:
 - Large format (42” x 36”) maps
 - DVD of Adobe small format (8.5” x 14”) census block maps
- Digital
 - Available to all governments
 - TIGER partnership shapefiles (LUCA specific)
 - Utilize GIS software

Paper – Large & Small Format Maps

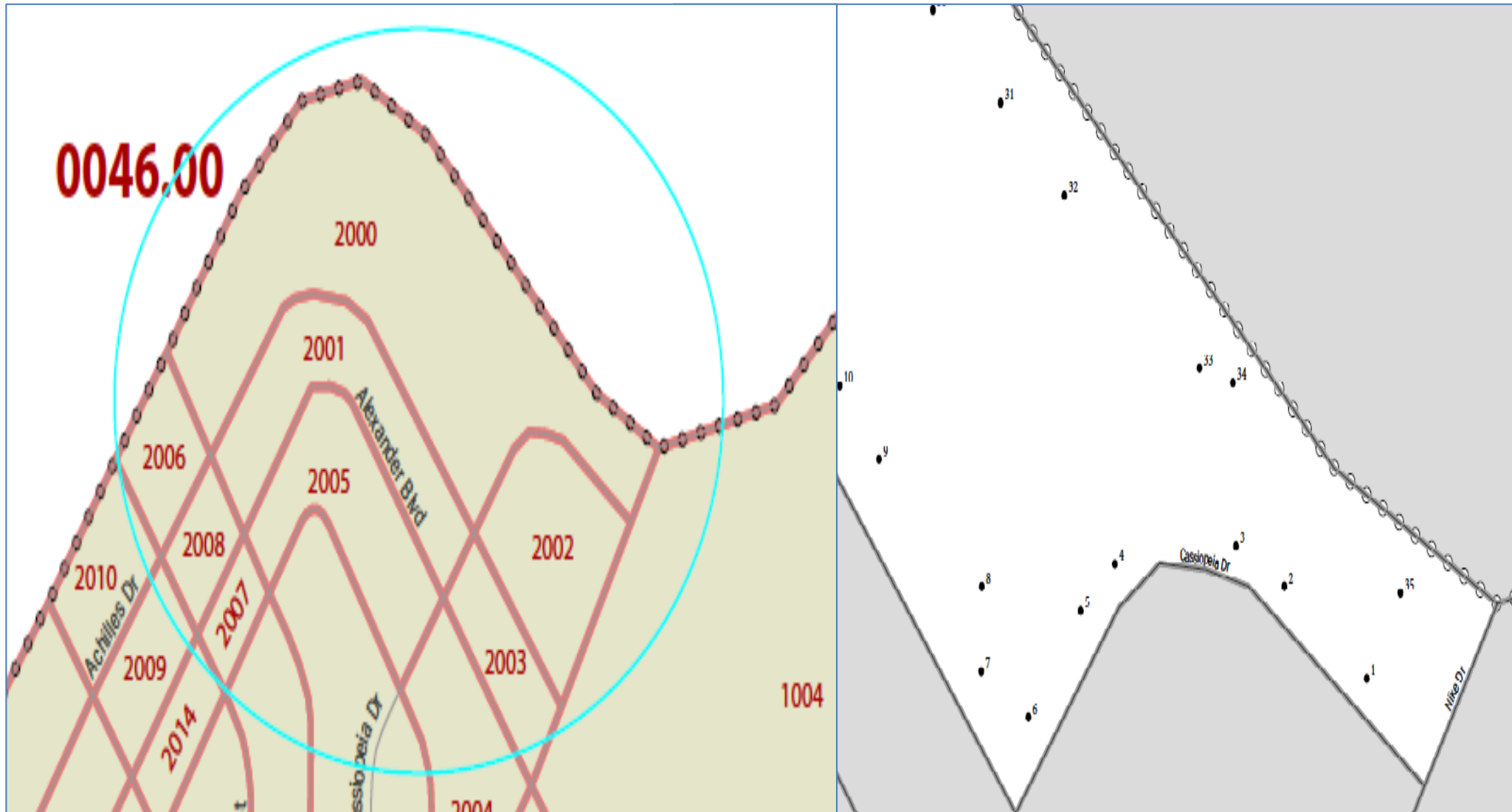

FICTITIOUS INFORMATION – FOR EXAMPLE ONLY

NO TITLE 13 DATA DISPLAYED

How to prepare for LUCA

- ✓ **Submit** Contact Information Update Form
- ✓ **Develop** a strategy for your address review
- ✓ **Review** the Census Bureau's count of residential addresses by census block for your government
- ✓ **Confirm** that your address list contains individual multi-unit structure identifiers (Apt 1, Apt 2)
- ✓ **Identify** local address sources such as building permits, E-911 address files, local utility records, annexation records, and assessment or taxation files
- ✓ **Plan** to attend a LUCA Promotional Workshop

Preparation – Next Steps (Participant)

- **Prepare** (now!)
- **Register** to participate (July 2017)
- **Attend** a training workshop (Fall/Winter 2017)
 - In-person workshops
 - Self-training aids and Webinars available online
- **Conduct** your LUCA review (Feb-April 2018)
 - **120** calendar days upon receipt of materials to complete review

Preparation - 2020 LUCA Schedule

Timeframe	Activity
January 2017 ✓	Advance Notice mailed to Highest Elected Officials (HEOs), Tribal Chairs (TCs), Governors, and other LUCA contacts
March 2017 ✓	LUCA promotional presentations begin
July 2017	LUCA invitation and registration materials mailed to HEOs, TCs, and Governors
October 2017	LUCA training workshops begin
December 15, 2017	Deadline for LUCA Registration
February-April 2018	LUCA materials ship. Participants begin review and update the Census Bureau's address list
February-September 2018	Census Bureau processing of LUCA submissions begins
August-September 2019	Census Bureau delivers LUCA feedback
April 1, 2020	CENSUS DAY

Questions about 2020 LUCA?

Visit our 2020 LUCA website:

<https://www.census.gov/geo/partnerships/luca.html>

Contact us:

Via telephone: 1-844-344-0169

Via Email: GEO.2020.LUCA@census.gov

Connect with Us



Sign up for and manage alerts at
<https://public.govdelivery.com/accounts/USCENSUS/subscriber/new>



facebook.com/uscensusbureau



More information on the 2020 Census Memorandum Series:
<http://www.census.gov/programs-surveys/decennial-census/2020-census/planning-management/memo-series.html>



twitter.com/uscensusbureau



More information on the 2020 Census:
<http://www.census.gov/2020Census>



youtube.com/user/uscensusbureau



More information on the American Community Survey:
<http://www.census.gov/programs-surveys/acs/>



instagram.com/uscensusbureau



pinterest.com/uscensusbureau